

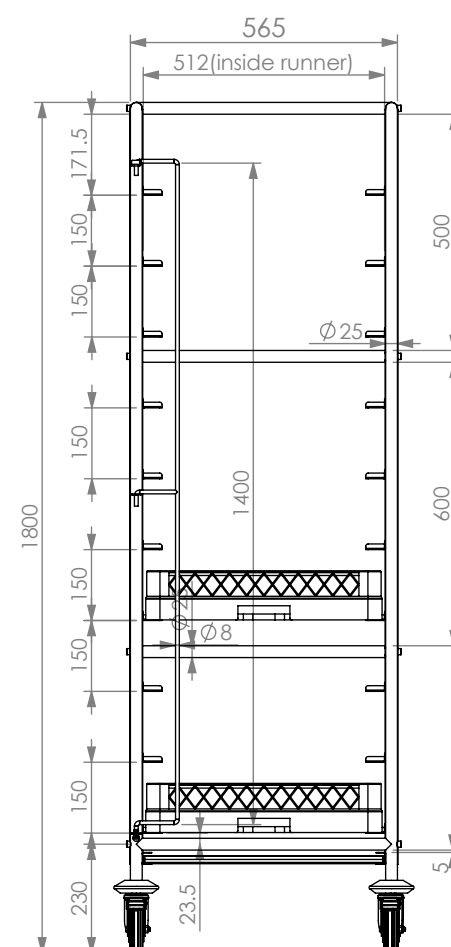

A tall, narrow stainless steel rolling cart. It features a central vertical divider and multiple horizontal shelves on both sides. The cart is mounted on four casters at the base.



SPECIFICATION	
Frames	<ul style="list-style-type: none"> - 25x25x1.2mm stainless steel round tube. - Heavy duty nylon \varnothing 100mm swivel castors, 2x locking and 2x non-locking.
Runners	<ul style="list-style-type: none"> - 1.2mm gauge, no. 4 Finnish. - High quality stainless steel.
Shelf	<ul style="list-style-type: none"> - Removeable shelf - 1.2mm gauge, no. 4 Finnish. - High quality stainless steel.



100%
RECYCLABLE
STAINLESS STEEL